

**3M** Science.  
Applied to Life.™

# 6 steps to confirm appropriate fit.

**3M™ Eyewear Fit System FS200**  
For Protective Eyewear



The 3M™ Eyewear Fit System is a process that goes beyond normal sizing and adjustment. It lets you help workers on an individual basis, taking into consideration both fit and comfort.

\*Actual case may differ

## 6-step system

Simple. Helps you confirm eyewear fit on a worker-by-worker basis.

## Quick and easy:

Online access to instructions, which allow quick and easy employee evaluations.

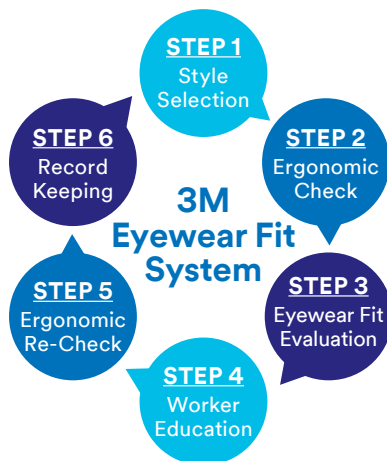

## You get:

- 3M-exclusive toolkit for conducting evaluations
- Access to methodology for comparing different styles/models of protective eyewear and determining best individual option(s)

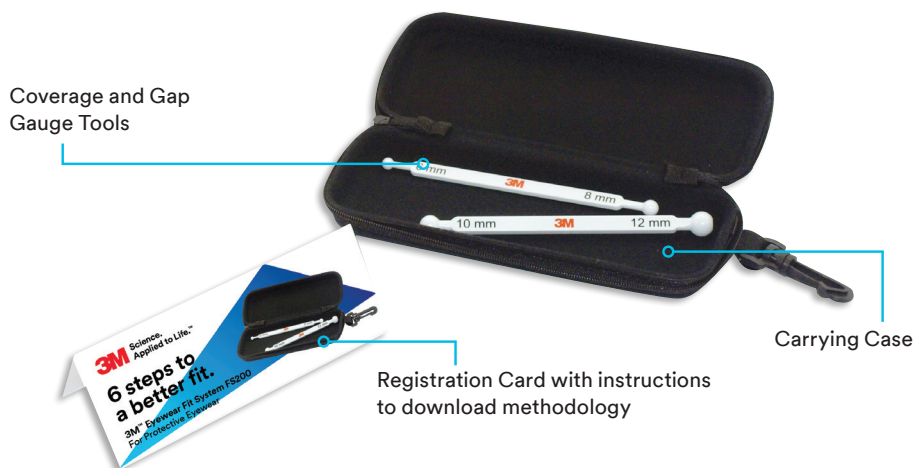

\*It is the responsibility of the employer to determine if the eyewear is suitable for the application based on the worksite hazard assessment and applicable standards.

**For a free demo and/or more information, contact your 3M representative. For more information on 3M Protective Eyewear, visit [3M.com/SEE3M](https://www.3m.com/SEE3M)**

### ⚠ WARNING

These eye and face protection products help provide limited eye and face protection. **Misuse or failure to follow warnings and User Instructions may result in serious potential injury, including blindness or death.** For proper use, selection, and applications against flying particles, optical radiation and/or splash, see supervisor, read *User Instructions* and warnings on the package or call 3M PSD Technical Service in the USA at 1-800-243-4630. In Canada, call Technical Service at 1-800-267-4414.

## Finding appropriate fit

Assessing size and adjustable features of protective eyewear is important. But it's not always enough. The 3M™ Eyewear Fit System goes further, evaluating protective eyewear fit on four levels.

### Eyewear Fit Evaluation

#### 1 View

Confirm the wearer can see in all directions of eye rotation without major obstruction to the field of view necessary to perform work tasks.

#### 2 Security

Check that the eyewear stays in place on the wearer's head and does not fall off with head movement.

#### 3 Coverage

The Coverage Gauge assesses how well the eyewear shields the soft tissue area around the eyes.

#### 4 Gaps

The Gap Gauges help identify excessive space between eyewear and the face—gaps that can open up a path for flying debris.



**Personal Safety Division**  
3M Center, Building 235-2W-70  
St. Paul, MN 55144-1000

#### For more information: In U.S.

Technical Assistance 1-800-243-4630  
Customer Care Center 1-800-328-1667  
[3M.com/workersafety](https://www.3m.com/workersafety)

#### In Canada

Technical Assistance 1-800-267-4414  
Customer Care 1-800-364-3577  
[3M.ca/safety](https://www.3m.ca/safety)

3M is a trademark of 3M Company, used under license in Canada. Please recycle. Printed in U.S.A. © 3M 2018. All rights reserved. 3M PSD products are occupational use only. 70-0716-7114-6